

Chillicothe Municipal Utilities CT Metering Standard - 3 Phase Installation

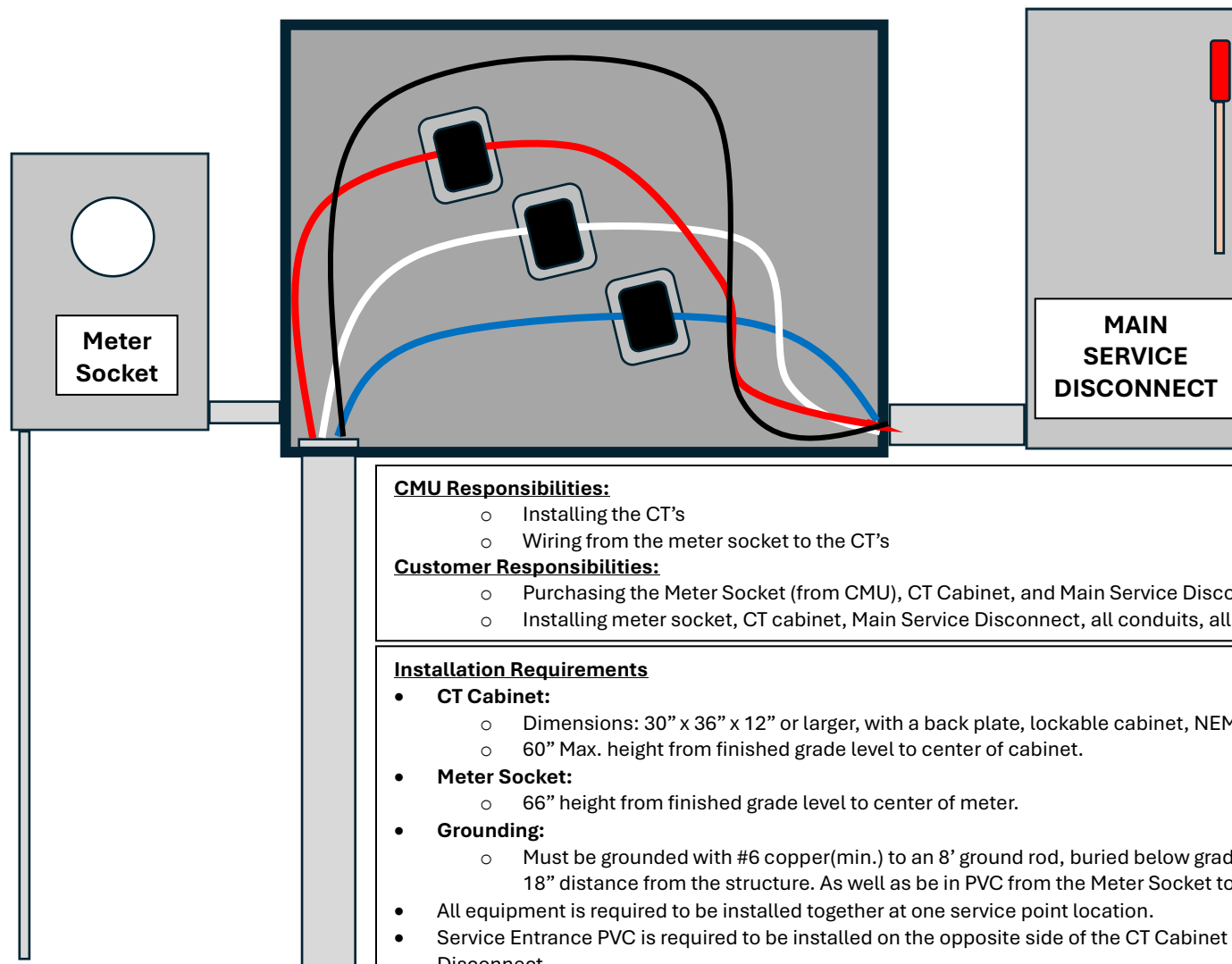

CMU Responsibilities:

- Installing the CT's
- Wiring from the meter socket to the CT's

Customer Responsibilities:

- Purchasing the Meter Socket (from CMU), CT Cabinet, and Main Service Disconnect.
- Installing meter socket, CT cabinet, Main Service Disconnect, all conduits, all grounding, and conductors.

Installation Requirements

- **CT Cabinet:**
 - Dimensions: 30" x 36" x 12" or larger, with a back plate, lockable cabinet, NEMA 3R Rated.
 - 60" Max. height from finished grade level to center of cabinet.
- **Meter Socket:**
 - 66" height from finished grade level to center of meter.
- **Grounding:**
 - Must be grounded with #6 copper(min.) to an 8' ground rod, buried below grade level 18" and maintain an 18" distance from the structure. As well as be in PVC from the Meter Socket to ground level.
- All equipment is required to be installed together at one service point location.
- Service Entrance PVC is required to be installed on the opposite side of the CT Cabinet from the Main service Disconnect.
- Minimum 1" Diameter piping required from the meter socket to CT cabinet.
- Main Service Disconnect required on all CMU infrastructure.
- All equipment must:
 - Be accessible by CMU personnel **AT ALL TIMES.**
 - Maintain 36" distance from any exterior door/ window.
- Any variation of this drawing will have to be approved by the Electric Superintendent in a written document.
- **ALL SERVICES 400 AMP AND LARGER MUST HAVE A ONE LINE DRAWING WITH AN ENGINEERED STAMP BEFORE APPROVAL BY CMU.**